

1.1.2.6 Medium - High Power Fan Cooled Thermal Sensors

10mW to 150W

Features

- General purpose and high damage threshold
- Fan cooled
- Powers to 150W
- Ø17.5mm to Ø35mm apertures
- F50A-BB-18 very stable reading and wide dynamic range

F50A-BB-18



F100A-PF-DIF-33



F150A-BB-26



Model	F50A-BB-18	F100A-PF-DIF-33	F150A-BB-26
Use	Monitoring stability of power	Short pulse lasers	General purpose
Absorber Type	Broadband	PF type + diffuser	Broadband
Spectral Range μm	0.19 - 11	0.24 - 2.2	0.19 - 11
Aperture mm	Ø17.5mm	Ø33mm	Ø26mm
Power Mode			
Power Range	10mW - 50W ^(a)	50mW - 100W ^(d)	50mW - 150W ^(d)
Power Scales	50W / 5W / 500mW	100W / 30W / 3W	150W / 30W / 3W
Power Noise Level	0.5mW	6mW ^(c)	3mW ^(c)
Maximum Average Power Density kW/cm ²	17 at 50W 28 at 10W	>6	12 at 150W 17 at 50W
Response Time with Meter (0-95%) typ. s	0.8	2.5	1.5
Calibration Uncertainty $\pm\%$	1.9	1.9	1.9
Power Accuracy $\pm\%$	3 ^(e)	5 ^(c)	3 ^(e)
Linearity with Power $\pm\%$	1	1.5	1
Energy Mode			
Energy Range	6mJ - 50J ^(a)	60mJ - 200J	20mJ - 100J
Energy Scales	50J / 5J / 500mJ	200J / 30J / 3J	100J / 30J / 3J / 300mJ
Minimum Energy mJ	6	60 ^(d)	20 ^(d)
Maximum Energy Density J/cm ²			
<100ns	0.3	4 ^(b)	0.3
0.5ms	2	15 ^(b)	5
2ms	2	35 ^(b)	10
10ms	2	50 ^(b)	30
Cooling	fan	fan	fan
Fiber Adapters Available (see page 118)	ST, FC, SMA, SC	NA	ST, FC, SMA, SC
Weight kg	0.35	0.8	0.35
Compliance	CE, UKCA, China RoHS	CE, UKCA, China RoHS	CE, UKCA, China RoHS
Version	V1		V1
Part number: Standard Sensor	7Z07121	7Z02744	7Z07120
BeamTrack Sensor: Beam Position & Size (p. 62)			7Z07906

Notes: (a) Fan should be on for power above 3W. Fan should be off for measuring very low power and for energy measurement.

Notes: (b) For shorter wavelengths derate maximum energy density as follows: Wavelength Derate to value:

1064nm	not derated	355nm	60% of stated value
532nm	80% of stated value	266nm	40% of stated value
		193nm	NA

Notes: (c) Calibrated at specified wavelengths only: 266nm, 355nm, 532nm, 1064nm and 2100nm only

Notes: (d) For lower powers up to 30W it is recommended to work with the fan off and then the noise level is ~3 times lower. It is also recommended to measure energy with the fan off.

Notes: (e) $\pm 4\%$. For wavelengths <240nm

F50A-BB-18

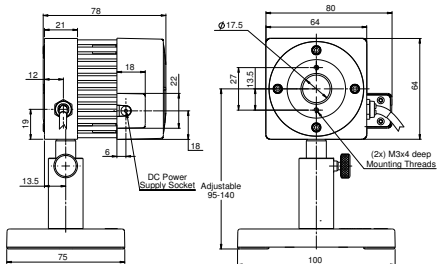

F100A-PF-DIF-33

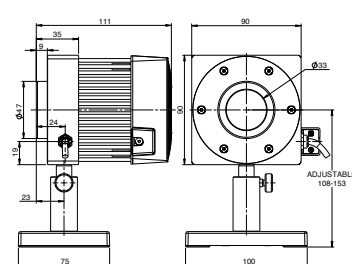

F150A-BB-26

